

FIREGAS

INSTALLATION AND USER'S MANUAL

FIREGAS

Thanks for reading.
We wish you a lot of fun cooking

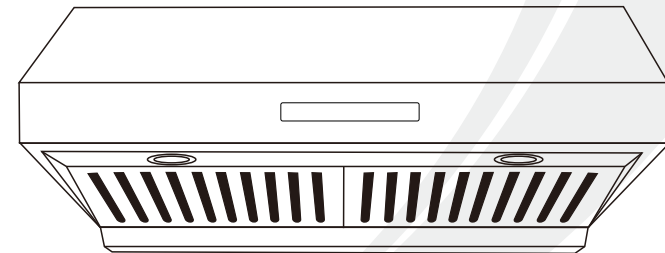

FGS-USF27B75CC

IMPORTANT NOTICE:
Read and save these instructions.
Installer: Leave this guide with the homeowner.
Homeowner: Keep this guide for future reference.



www.firegaskitchen.com

CONTENT

Introduction	2
Safety Precaution	2
Parts Diagram	3-4
Installation Instructions	4-5
Air Outlet Installation Method	6
Installation	6-7
Operation	8
Maintenance	9
Trouble-Shooting	10
Environmental Protection	10

NOTE:

You can also watch the installation video from **Support > Installation Guide** by visiting our website: **www.firegaskitchen.com**
We will update at any time, please visit the website for more information.

Introduction

Thank you for choosing this cooker hood.

- This instruction manual is designed to provide you with all required instructions related to the installation, use and maintenance of the appliance.
- In order to operate the unit correctly and safely, please read this instruction manual carefully before installation and usage.

Safety Precaution

- Never let the children operate the machine.
- The cooker hood is for home use only, not suitable for barbecue, roast shop and other commercial purpose.
- Clean the cooker hood according to the instruction manual and keep the unit from danger of burning. There is a fire risk if cleaning is not carried out in accordance with the instructions.
- Please keep the kitchen room a good convection before connecting this appliance; Please check that the power supply cord is undamaged. A damaged supply cord must be replaced by qualified service personnel only.
- Regulations concerning the discharge of air have to be fulfilled.
- This appliance can be used by children aged from 8 years and above also the persons with reduced physical, sensory or mental capabilities or lack of experience and knowledge if they have been given supervision or instruction concerning use of the appliance in a safe way and understand the hazards involved. Children shall not play with the appliance. Cleaning and user maintenance shall not be made by children without supervision.
- If the supply cord is damaged, it must be replaced by the manufacturer, its service agent or similarly qualified persons in order to avoid a hazard.

CAUTION:

Accessible parts may become hot when used with cooking appliance.

Electrical Shock Hazard

Only plug this unit into a properly earthed outlet.

If you have doubts, seek advice from a suitably qualified engineer.

Parts Diagram

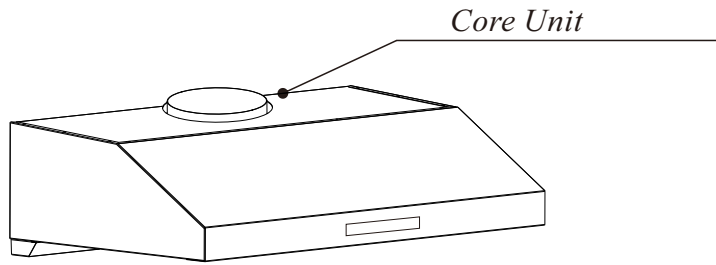

Parts Supplied



Mounting bracket

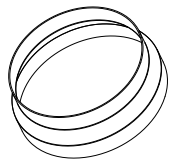

7" change to 6" Adapter

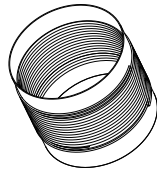

Pipe



× 10

St4 × 30



× 10

φ 8 × 35



× 6

M5 × 10



× 6

Washer

Tools Required



Pencil



Measuring tape

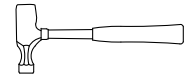

Hammer

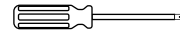

Screwdriver



Level

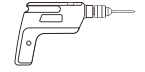

Electric drill

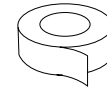

Duct Tape

Installation Instructions

Prepare for installation:

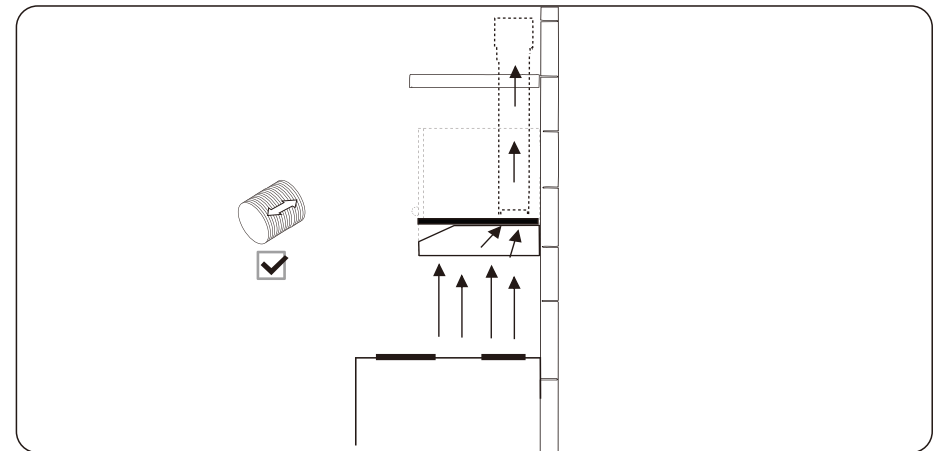

DUCTED OPTION

If you have an outlet to the outside, your cooker hood can be connected as above picture by means of a pipe (with an interior diameter of 150mm).

Installation Requirements

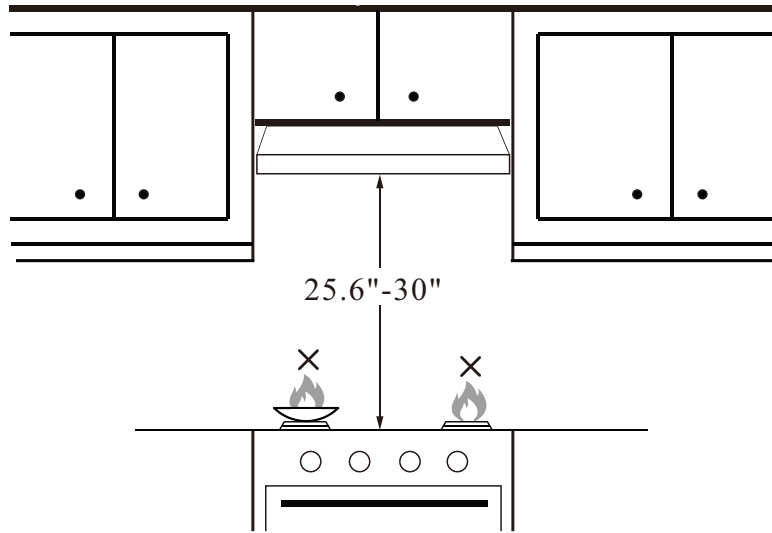

The cooker hood should be placed at a distance of 25.6"~30" above the cooktop for the best effect.



Note

No open flames directly approach to the range hood.

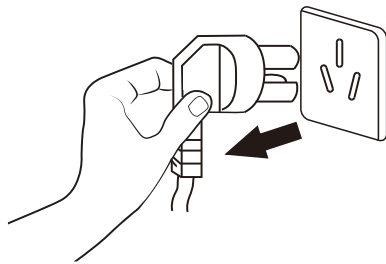

Before installation, turn the unit off and unplug it from the outlet.

Note: The power cord is 1.1 meters. It is not recommended that user replace the power cord or cut the power cord.

Air Outlet Installation Method

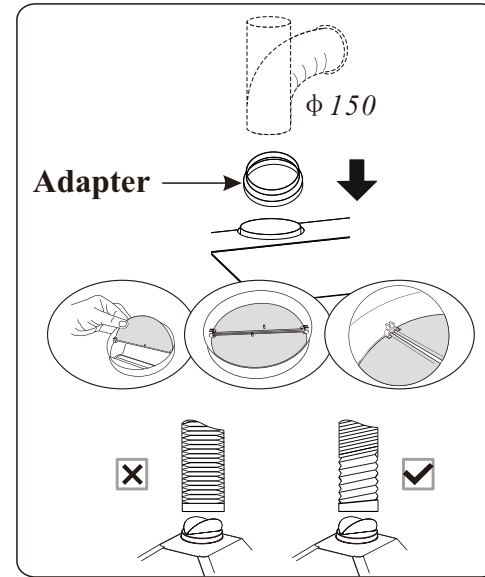

Installation method for 150mm diameter pipe: insert the one-way-value as the pic and fix the duct.

Attention: The bump of the one-way-value must be upward.

The pipe near the air outlet need to be fully extended.

Installation



Note

Please connect the power supply to test and confirm that the power is on before installing this under cabinet range hood.

Refer to the installation instructions:

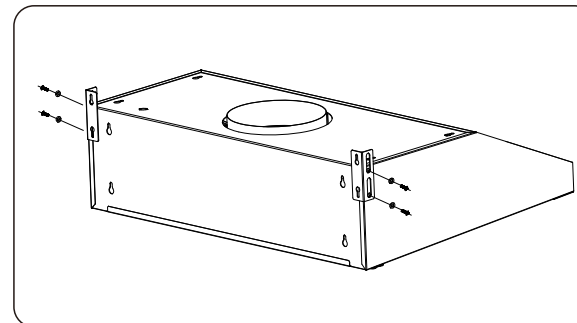

Connect the hooks, gaskets and screws to the unit by screwdriver.

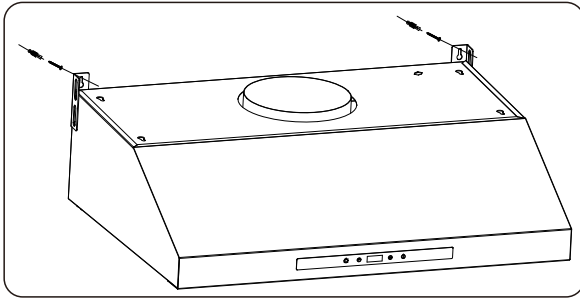

Screw the anchor screws to suitable location, then hook on, lock screws.

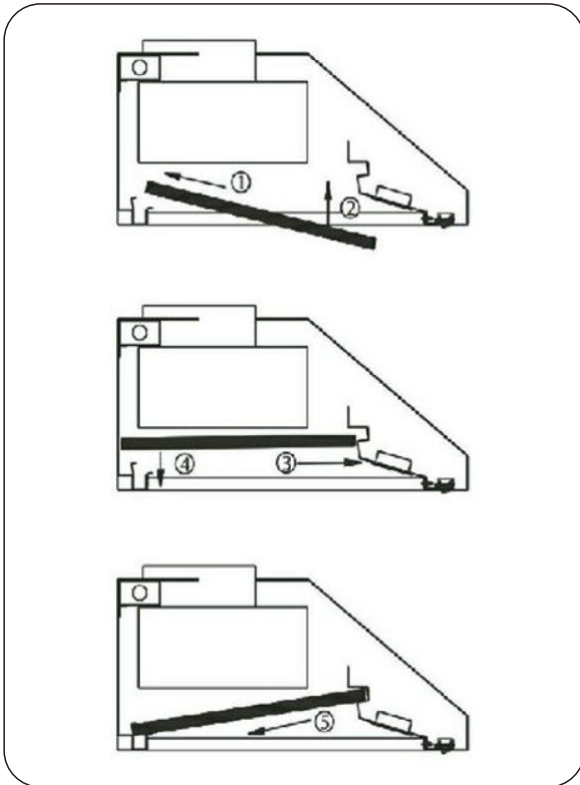

Install baffle filters:

1. Angle baffle filter toward back of hood.

2. Push baffle filter up until almost level.

3. Slide forward into recess behind the front of the hood.

4. Lower baffle filter.

5. Slide back until it fits into resting positions.

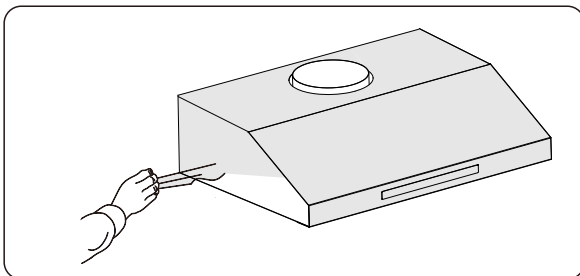

⚠ CAUTION:
BEFORE USE
 Please remove the white/blue protective film on the rangehood.

Operation

Touch control



Connect to the power, it access into standby mode with “Bi” sound. LED screen shows time in blue color and only light button can be operated. In activated mode, all icons are not illuminated.

⏻ During standby mode, press the ON/OFF button for 0.5 sec to access activated mode. In activated mode, this button is illuminated and speed button can be operated. Press ON/OFF button again can access into standby mode.

🌀 During activated mode, press speed button to operate the machine from 1st speed - 2nd speed - 3rd speed - Stop.

⌚ a, Delay function: When machine is running, press timer button to access into delay function. Choose the time and without any operation for 10s, the machine will start the count down and will be off after count down is finishing.

Delay timer setting: Default time is 3 mins. When the delay button is flashing, press this button to increase minutes. (Delay timer can be set from 1-60mins)

Count down mode: The timer button illuminates in blue and the machine will create “Bi” sound at the last 3 sec to finish the count down. If you want to stop the count down, press this button again to exit this mode.

b, Timer setting function: During standby or activated mode, press this button for 1s to access into timer setting function with the LED screen timer flashing. Press timer button to increase hour and press light button to increase min. After setting, press this button again or wait for 10 sec without any operation to settle down the timer.

💡 Press light button to control light ON or OFF.

Maintenance

Before cleaning switch the unit off and pull out the plug.

I. Regular Cleaning

Use a soft cloth moistened with hand-warm mildly soapy water or household cleaning detergent. Never use metal pads, chemical, abrasive material or stiff brush to clean the unit.

II. LED Light Replacement

Switch the unit off and unplug the appliance.

CAUTION: LAMP UNIT MAY BE HOT!

WAIT UNTIL THE UNIT IS COOL. BEFORE attempting to replace the LED lamps make sure the unit is powered off and UNPLUGGED.

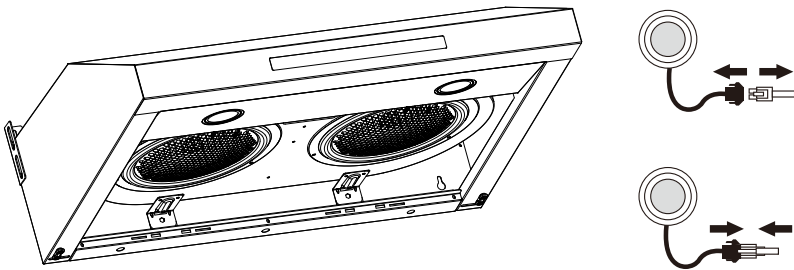

III. Filter



1 MONTHS

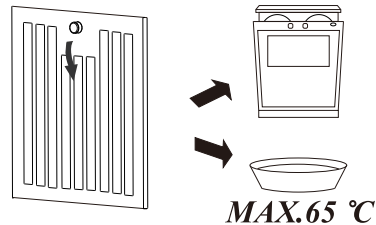

Filters: To avoid fires, clean thoroughly once a month or whenever the display pilot lights up (if fitted). To do so, remove the filters and soak in hot water and detergent for an hour. If using a dishwasher, position the filters vertically to improve the cleaning process.

Trouble-Shooting

Fault	Cause	Solution
Light on, but fan does not work	The fan blade is jammed.	Switch off the unit and repair by qualified service personnel only.
	The motor is damaged.	
Both light and fan do not work	Light is burnt out.	Replace the LED light with correct rating.
	Power cord is loose.	Plug into the power supply again.
Serious Vibration of the unit	The fan blade is damaged.	Switch off the unit and repair by qualified service personnel only.
	The fan motor is not fixed tightly.	
	The unit is not hung properly on the bracket.	Take down the unit and check whether the bracket is in proper location.
Suction performance not good	Too far distance between the unit and the cooktop.	Readjust the distance between 25.6"-30"

Environmental Protection

Waste electrical products should not be disposed of with household waste. Please recycle where facilities exist.

Check with your Local Authority or retailer for recycling advice.



FIREGAS

Statement

Thank you for purchasing this product. FIREGAS is committed to providing our customers with professional quality kitchen ventilation.

This document is designed to act as a quick reference guide for common scenarios and questions when installing a FIREGAS cooker Hood. for more instructions and details please refer to Installation Guide from www.firegas.kitchen.com

Customer Service

If there is a problem with the cooker hood, you can contact customer service for a solution.

Email: support01@firegaskitchen.com

Website: www.firegaskitchen.com

Warranty

For full warranty details on this product please visit: www.firegaskitchen.com
Support > Warranty Registration

Product	Model
Sr. No. of Product	
Cash memo no./ Date of Sale	
Name & Address / Stamp of Dealer	
Signature of Dealer	